

Triple-Cutter Turning Head

Fast and precise reduction of diameters:

- Central fine adjustment of the diameter
- Turning range 2 - 16 mm
- Great diameter reductions in one work unit
- High turning precision and perfect surfaces
- For small and great numbers of turning parts
- Stationary and rotating design



The **DSD 16** is equipped with three precision-ground WAGNER[®] carbide reversing plates or with standard cutting inserts (forms SMCT or CCMT).

Compared to common tools holding only one insert, the DSD 16 holds great advantages.

Higher removing capacity: The three carbide inserts cause a chip division into three equal parts. The chip thickness at one edge measures only $\frac{1}{3}$ of the total feed rate. This brings up the possibility of considerably higher advances.

Precision: the work piece is balanced due to the three cutting edges. Turning precision of 0.01 - 0.02 mm in diameter is thus possible even for great chipping lengths.

Because of the unmistakably fixed position, the **turning plates can be build into the holder** quickly and easily.

The turning diameter can be pre-adjusted in 2 mm steps, as the three holders of the turning plates and the three slide valves at the DSD 16 come with a precise cogging with a 1 mm scale.

The fine adjustment of the diameter is done centrally for all three holders of turning plates. Diameter corrections can thus be easily done in the machine.

Materials and shapes:

- all machinable material, even wood and synthetics
- the material can be round, square or hexagonal, rolled or pulled.

Range of Tools:

- Thread Rolling Attachments
- Thread Rolling Heads
- Thread Cutting Heads
- **Multi-Cutter Turning Heads**
- Driven Tools

More precise

Faster

Cheaper

More robust



**WAGNER[®] - Werkzeugsysteme
Müller GmbH**

Gutenbergstraße 4/1
D-72124 Pliezhausen
Phone +49 (0)71 27 / 97 33 00
Fax +49 (0)71 27 / 97 33 90
www.wagner-werkzeug.de
info@wagner-werkzeug.de

Triple-Cutter Turning Head

For the reduction of diameters.

The DSD 16 in **stationary design** is suitable for the use on one- or multi-spindle lathes as well as on CNC lathes.

The **rotating type** is designed for the use on right turning rotary transfer machines, automatic lathes, indexing table machines, cycle-, transfer- and special machines.

For the insertion into the machine we offer a number of shanks and flanges.



The **WAGNER**[®] -Triple-Cutter Turning Head with VDI-shank.



The **WAGNER**[®] -Triple-Cutter Turning Head with KM-shank.

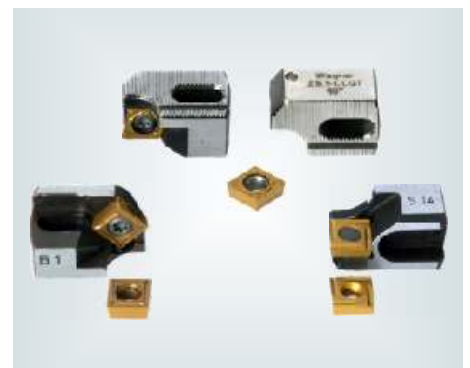

Cutting plates SCMT, CCMT and **WAGNER**[®]-carbide inserts

Dimensions

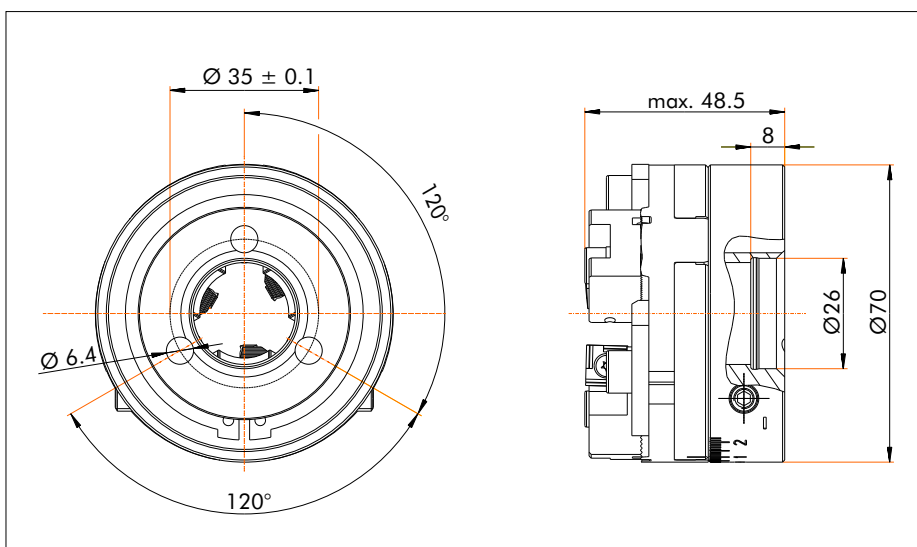
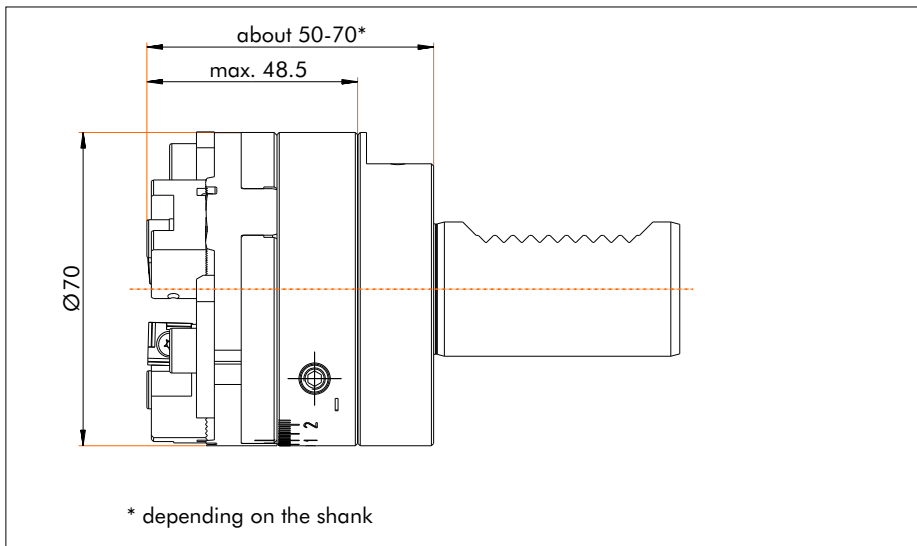

WAGNER[®]-Werkzeugsysteme
Müller GmbH
 Gutenbergstraße 4/1
 D-72124 Pliezhausen
 Phone +49 (0)71 27 / 97 33 00
 Fax +49 (0)71 27 / 97 33 90
www.wagner-werkzeug.de
info@wagner-werkzeug.de